

1. Tile ROCKFON, edge B
2. Cosmos Hook/Fittings
3. Wall Angle 24/24 3050 white
4. Wooden lath

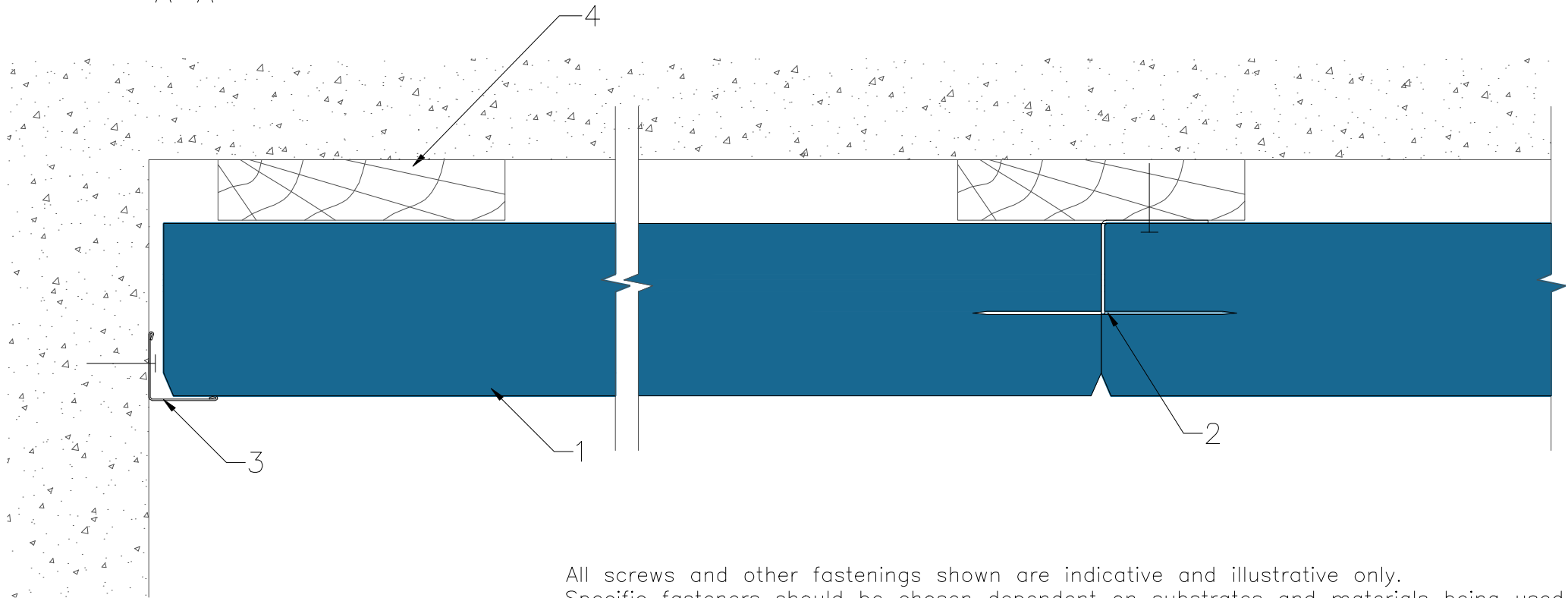

All screws and other fastenings shown are indicative and illustrative only.  
 Specific fasteners should be chosen dependent on substrates and materials being used.

|   |  |  |               |               |
|---|--|--|---------------|---------------|
| Information:<br><br><br>We kindly draw your attention to the fact that the above drawings should be considered as guidelines and therefore are without responsibility on the part of Rockfon. | Date:<br>25.02.2014                        |  | Drawing Type: |               |
|   | Drawing No.:<br>11.1.2.Rockfon B srew/hook |  | Drawn by:     | Scale:<br>1:2 |
|   | Contact Information:                       |  |               |               |

